

Thank you for choosing our product !

LEVITY

The Ora Medical team is excited to accompany you as you take your first steps with Levity !

by ORA Medical Inc.

Share your experience with us on Instagram by tagging @ora_medical.

Unpacking the Levity

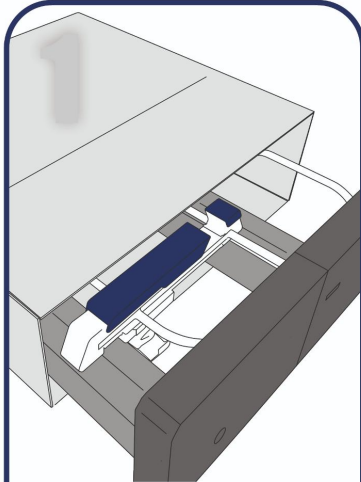

Take the device out of the box and make sure all items included in your order are present.

Tip: Lay the package on its widest side to slide the device out of the box.

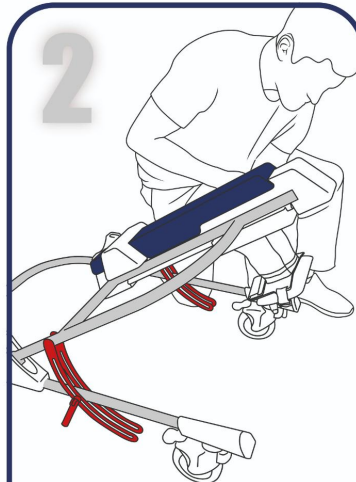

Loosen the levers on the sides and unfold the upper frame.

Tip: Hold the bottom frame with one hand and pull the upper frame with your other hand.

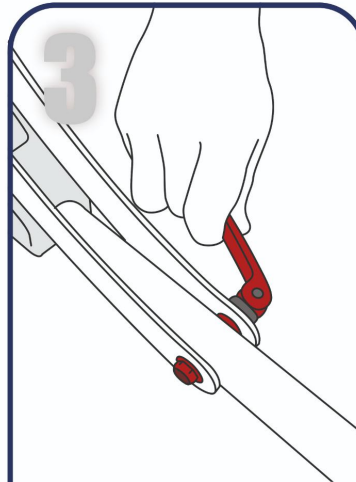

Ensure that the sliders are securely engaged in the safety grooves and tighten the levers on the sides.

Tip: Press on the sliders to ensure they are well engaged in the grooves.

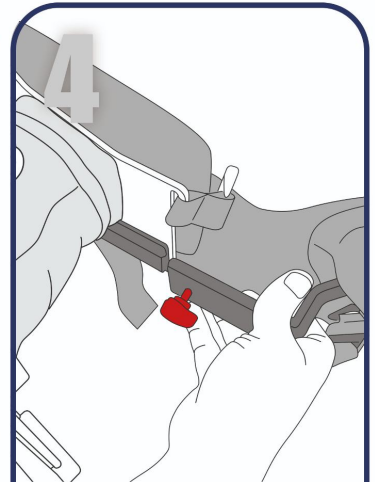

Insert the hip cushions on each side onto the harness rail and tighten the handles to secure their position.

Tip: Make sure the harness is untangled before installing it.

Installing the User

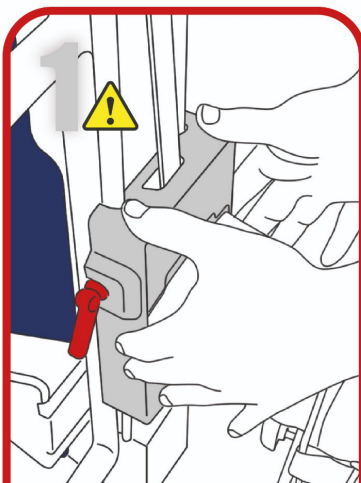

Lower the harness to the user's hip level and lock the carriage brakes.

Warning: Securely engage the brakes to prevent any movement of the cart.

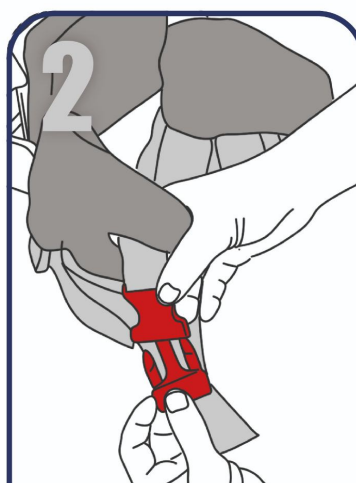

Place the user facing away from the device, pass the straps between the user's legs, and attach the front buckles. Adjust the straps for improved comfort.

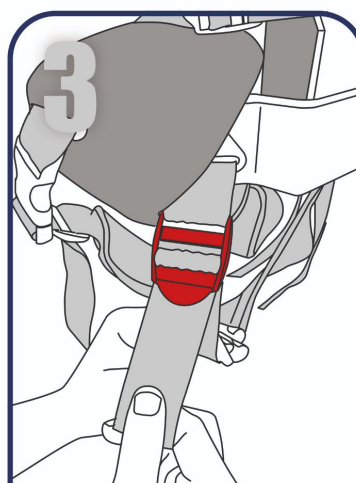

The rear straps can also be adjusted to enhance the comfort and posture of the user.

Tip: Adjust the straps before installing the user in the harness.

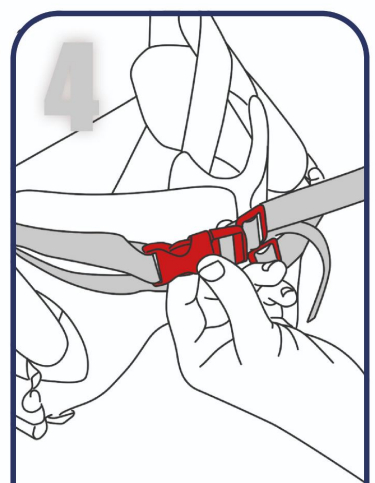

Fasten the belt around the user's belly. Adjust the straps for improved comfort.



Refer to the user manual.

Contact Us

+1 (514) 839-1773
info@oramedical.ca
80 rue Queen, Montréal, QC H3C 2N5,
CANADA

Download the app

Easily track your child's progress
by downloading the app.

IOS



Android



Changing Settings

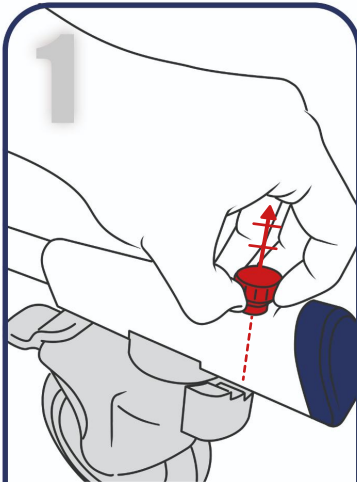

Directional control

High position: No direction limitation

Intermediate position: Partial limitation of direction

Low position: Directional lock

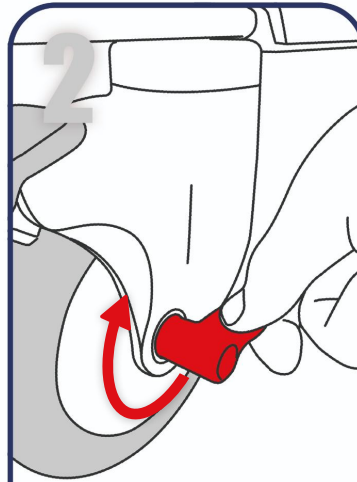

Speed control

Turn the handle clockwise to limit the speed of movement.

Tip: Adjust both wheels identically to avoid influencing the direction of movement.

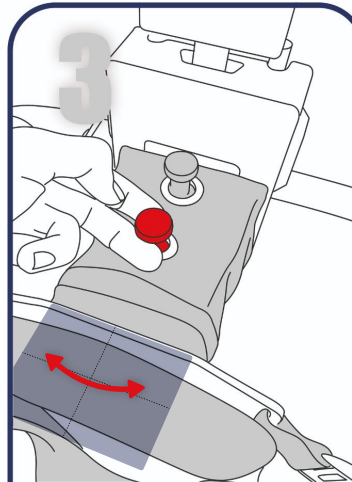

Control of harness movements on the transverse plane

High position: Movement allowed on the transverse plane

Low position: Movement blocked on the transverse plane

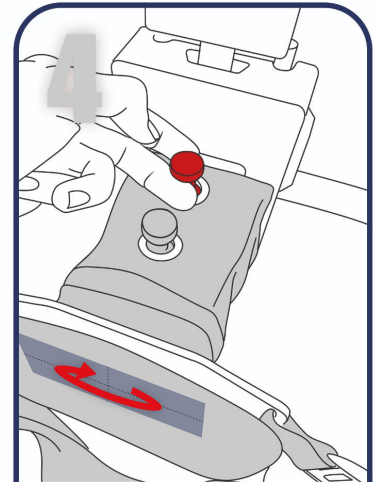

Control of harness movements on the frontal plane

High position: Movement allowed on the frontal plane

Low position: Movement blocked on the frontal plane

Changing the Spring Housing

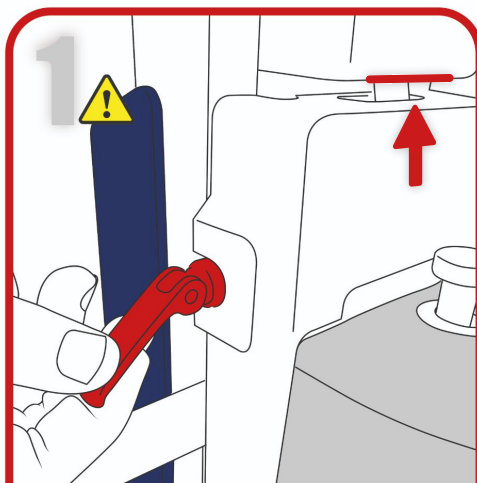

Lift the harness completely and firmly lock the brakes.

Warning: Securely engage the brakes to prevent any movement of the cart.

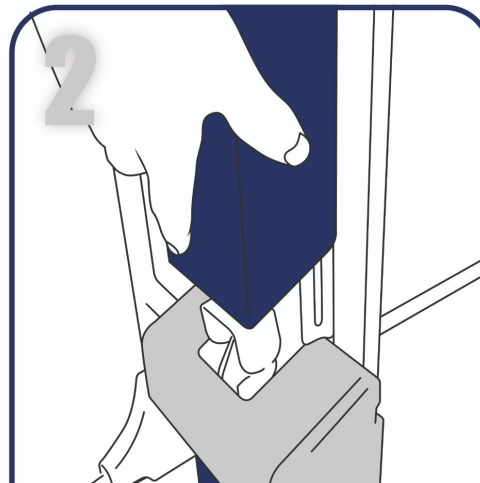

Lift the rear cover and detach the buckle between the housing and the belt.

Warning: Ensure that the harness is at its highest position on the rail at the front of Levity before detaching the buckle.

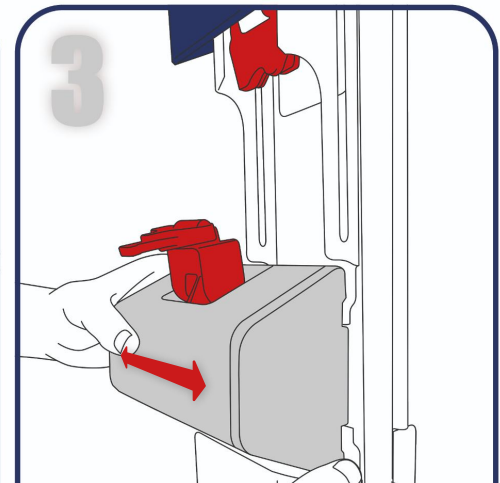

Slide the housing to the side to remove it. Slide the new housing into the slides, attach the belt buckle, and close the rear cover.

Warning: Both housing slides must be well engaged and the buckle must be securely attached.



Refer to the user manual.